

● ● ● ● ● ● Фиттинг рукавов PTFE / Fittings for PTFE hose

Страница / Page		2	2	3	3	5					
Ghiere Ferrule		TTP1 Per Tubo 'T' For 'T' hose		TTC Per Tubo 'TC' For 'TC' hose	GAS BSP		T051 BSP straight 60° cone		T151 BSP 90° 60° cone		T350 BSP Male
	Страница / Page		4	4		5					
Metric Metrico		T100 Metric straight 60° cone	Jic		T901 Jic straight 37° Flare	Male BSPT		T360 BSPT Male Maschio BSPT			
	Страница / Page			6	6		7				
Male NPT		T370 NPT Male Maschio NPT	Occhio Banjo		T140 Banjo Occhio	Ermeto Standpipe		T550 Ermeto - Standpipe DIN 3901			
	Страница / Page			7	8		8	9			
Flange		TPFO Porta Flangia		TPFR Porta Flangia rivestita PTFE		TFPG Flangia Piana Girevole	Female Reusable		TR51 BSP Female Reusable		

Dimensions and general characteristics may be changed at any time without prior notice.

Data contained herein are for information purpose only, and it does not enlarge, amend or imply any warranty other than provided by us with the product
Any use of the product not in conformance with our instructions may be dangerous.

0TP1 Обжимная муфта

Swaged Ferrule

для рукава / for hose:

TP1 - TM1 - T2 - THP

Материал (std): Бронза - UNI 5705-65

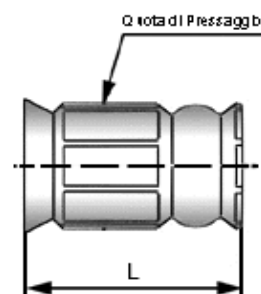
Material (std): Brass - UNI 5705-65

part number	hose I.D.		Dimensions		
	mm	inch	L	Диаметр обжима**	
0TP1-03	5	3/16"	16,5	10,8	
0TP1-04	6,5	1/4"	18	12,9	
0TP1-05	8	5/16"	20	14,4	
0TP1-06	9,5	3/8"	20	15,7	
0TP1-07	10,5	13/32"	20	16,7	
0TP1-08	13	1/2"	23,5	19,0	
0TP1-10	16	5/8"	22	22,6	
0TP1-12	19	3/4"	29	26,3	
0TP1-14	22	7/8"	28	29,3	
0TP1-16	25	1"	29	32,6	
0TP1-18	28,5	1.1/8"	30,5	36,9	
0TP1-20	32	1.1/4"	38	43,0	
0TP1-24	38	1.1/2"	38	49,2	
0TP1-50	50	2"	53	65,5	

 ** - Допуск: $\pm 0,5\%$ диаметра обжима

00TC Обжимная муфта

Swaged Ferrule

для рукава / for hose:

TC

Материал (std): Бронза - UNI 5705-65

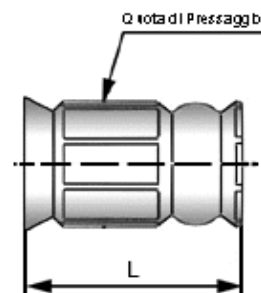
Material (std): Brass - UNI 5705-65

part number	hose I.D.		Dimensions		
	mm	inch	L	Диаметр обжима**	
00TC-04	6,9	1/4"	26	10,8	
00TC-06	9,5	3/8"	20	12,9	
00TC-08	13	1/2"	21	14,4	
00TC-10	16	5/8"	22	15,7	
00TC-12	19	3/4"	28	16,7	
00TC-16	25	1"	29	19,0	
00TC-20	32	1.1/4"	38	22,6	
00TC-24	38	1.1/2"	38	26,3	
00TC-50	51	2"	53	29,3	
*** 00TC-51	51	2"	53	32,6	

 ** - Допуск: $\pm 0,5\%$ диаметра обжима

*** - Используйте исключительно детали покрытые P.T.F.E

T051 Накидная гайка BSP 60°
BSP Female 60° cone
Материал (std): ниппель : Бронза - UNI 5705-65 / Гайка: сталь - UNI 5105

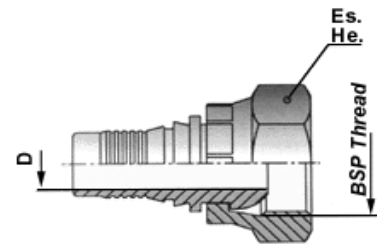
Material (std): insert: Brass - UNI 5705-65 / Nut: steel - UNI 5105

part number	hose I.D.		Dimensions			
	mm	inch	Thread	D	He	
T051-03-02	5	3/16"	1/8"	3,5	14	
T051-04-04	6,5	1/4"	1/4"	4,5	19	
T051-05-06	8	5/16"	3/8"	5,5	22	
T051-06-06	9,5	3/8"	3/8"	7,0	22	
T051-06-08	9,5	3/8"	1/2"	7,0	27	
T051-07-08	10,5	13/32"	1/2"	8,0	27	
T051-08-08	13	1/2"	1/2"	10,0	27	
T051-10-12	16	5/8"	3/4"	12,5	32	
T051-12-12	19	3/4"	3/4"	15,0	32	
T051-12-16	19	3/4"	1"	15,0	38	
T051-14-16	22	7/8"	1"	18,0	38	
T051-16-16	25	1"	1"	20,0	38	
T051-18-20	28,5	1.1/8"	1.1/4"	24,0	50	
T051-20-20	32	1.1/4"	1.1/4"	27,0	50	
T051-24-24	38	1.1/2"	1.1/2"	33,0	55	
T051-32-32	50	2"	2"	44,0	65	

T151 90° Накидная гайка BSP 60°
BSP 90° Swept elbow 60° cone
Материал (std): ниппель : Бронза - UNI 5705-65 / Гайка: сталь - UNI 5105

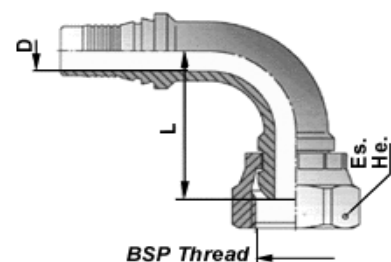
Material (std): insert: Brass - UNI 5705-65 / Nut: steel - UNI 5105

part number	hose I.D.		Dimensions			
	mm	inch	Thread	D	He	
T151-03-02	5	3/16"	1/8"	3,5	14	
T151-04-04	6,5	1/4"	1/4"	4,5	19	
T151-05-06	8	5/16"	3/8"	5,5	22	
T151-06-06	9,5	3/8"	3/8"	7,0	22	
T151-08-08	13	1/2"	1/2"	10,0	27	
T151-12-12	19	3/4"	3/4"	15,0	32	
T151-16-16	25	1"	1"	19,0	38	

T100 Ниппель метрика 60°

Metric Female 60° cone

Материал (std): ниппель : Бронза - UNI 5705-65 / Гайка: сталь - UNI 5105

Material (std): insert: Brass - UNI 5705-65 / Nut: steel - UNI 5105

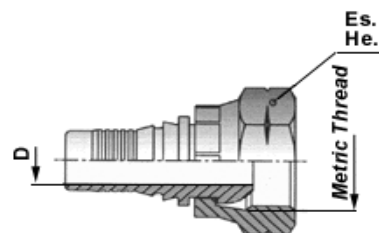

part number	hose I.D.		Dimensions			
	mm	inch	Thread	D	He	
T100-03-10	5	3/16"	10 x 1	3,5	14	
T100-04-12	5	1/4"	12 x 1	3,5	19	
T100-05-14	6,5	1/4"	14 x 1,5	4,5	19	
T100-06-16	8	5/16"	16 x 1,5	5,5	22	
T100-06-20	13	1/2"	20 x 1,5	10,0	24	
T100-07-22	13	1/2"	22 x 1,5	10,0	27	

T901 Ниппель JIC 74°

JIC Female 74° cone

Материал (std): ниппель : Бронза - UNI 5705-65 / Гайка: сталь - UNI 5105

Material (std): insert: Brass - UNI 5705-65 / Nut: steel - UNI 5105

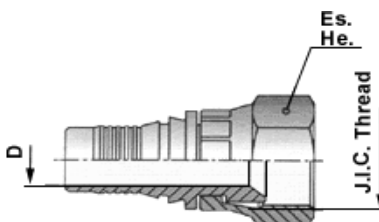

part number	hose I.D.		Dimensions			
	mm	inch	Thread	D	He	
T901-03-04	5	3/16"	7/16" - 20	3,5	15	
T901-04-05	6,5	1/4"	1/2" - 20	4,5	17	
T901-05-06	8	5/16"	9/16" - 18	5,5	19	
T901-05-05	8	5/16"	1/2" - 20	5,5	19	
T901-06-06	9,5	3/8"	9/16" - 18	7,0	19	
T901-07-08	10,5	13/32"	3/4" - 16	8,0	24	
T901-07-10	10,5	13/32"	7/8" - 14	10,0	27	
T901-08-08	13	1/2"	3/4" - 16	10,0	24	
T901-10-12	16	5/8"	1 1/16" - 12	12,5	32	

T350 Штуцер BSP конус 60°

BSP Male Parallel 60° cone

Материал (std): Бронза - UNI 5705-65

Material (std): Brass - UNI 5705-65

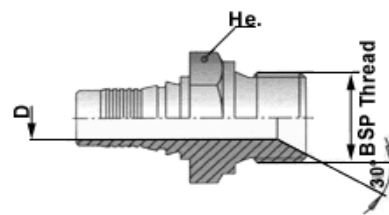

part number	hose I.D.		Dimensions			
	mm	inch	Thread	D	He	
T350-03-02	5	3/16"	1/8"	3,5	12	
T350-04-04	6,5	1/4"	1/4"	4,5	19	
T350-05-06	8	5/16"	3/8"	5,5	17	
T350-06-06	9,5	3/8"	3/8"	7,0	22	
T350-06-08	9,5	3/8"	1/2"	7,0	27	
T350-07-08	10,5	13/32"	1/2"	8,0	27	
T350-08-08	13	1/2"	1/2"	10,0	27	
T350-10-12	16	5/8"	3/4"	12,5	27	
T350-12-12	19	3/4"	3/4"	15,0	32	
T350-14-16	22	7/8"	1"	18,0	36	
T350-16-16	25	1"	1"	20,0	41	
T350-18-20	28,5	1 1/8"	1 1/4"	24,0	46	

T360 Штуцер BSPT конус 60°

BSP Taper Male 60° cone

Материал (std): Бронза - UNI 5705-65

Material (std): Brass - UNI 5705-65

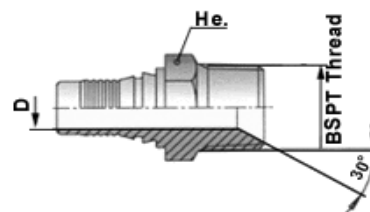

part number	hose I.D.		Dimensions			
	mm	inch	Thread	D	He	
T360-03-02	5	3/16"	1/8"	3,5	12	
T360-04-04	6,5	1/4"	1/4"	4,5	15	
T360-05-06	8	5/16"	3/8"	5,5	18	
T360-06-06	9,5	3/8"	3/8"	7,0	18	
T360-08-08	13	1/2"	1/2"	10,0	22	
T360-16-16	25	1"	1"	20,0	36	
T360-18-20	29	1 1/8"	1 1/4"	24,0	46	
T360-20-20	32	1 1/4"	1 1/4"	27,0	46	
T360-24-24	38	1 1/2"	1 1/2"	32,0	50	
T360-32-32	51	2"	2"	44,5	65	

T370 Штуцер NPTF конус 60°

NPTF Male 60° cone

Материал (std): Бронза - UNI 5705-65

Material (std): Brass - UNI 5705-65

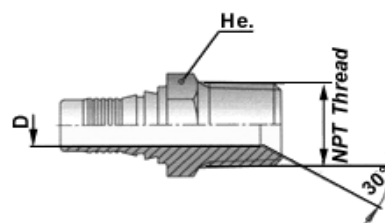

part number	hose I.D.		Dimensions			
	mm	inch	Thread	D	He	
T370-03-02	5	3/16"	1/8"	3,5	12	
T370-04-04	6,5	1/4"	1/4"	4,5	15	
T370-05-06	8	5/16"	3/8"	5,5	18	
T370-06-06	9,5	3/8"	3/8"	7,0	18	
T370-07-08	10,5	13/32"	1/2"	8,0	22	
T370-08-08	13	1/2"	1/2"	10,0	22	
T370-10-12	16	5/8"	3/4"	12,5	27	
T370-12-12	19	3/4"	3/4"	16,0	27	
T370-16-16	25	1"	1"	20,0	36	
T370-18-20	29	1 1/8"	1 1/4"	24,0	46	
T370-20-20	32	1 1/4"	1 1/4"	27,0	46	
T370-24-24	38	1 1/2"	1 1/2"	32,0	50	
T370-32-32	51	2"	2"	44,5	65	

T140 Банджо

Banjo

Материал (std): Бронза - UNI 5705-65

Material (std): Brass - UNI 5705-65

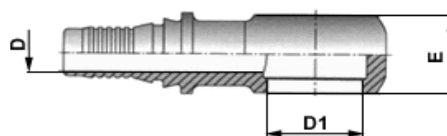

part number	hose I.D.		Dimensions			
	mm	inch	D1	D	E	
T140-03-10	5	3/16"	10,1	3,5	10	
T140-04-10	6,5	1/4"	10,1	4,5	10	
T140-04-12	6,5	1/4"	12,1	4,5	12	
T140-05-06	8	5/16"	16,7(3/8")	5,5	12	
T140-06-12	9,5	3/8"	12,1	7,0	15	
T140-06-04	9,5	3/8"	13,2(1/4")	7,0	15	
T140-06-14	9,5	3/8"	14,2	7,0	15	
T140-06-16	9,5	3/8"	16,2	7,0	15	
T140-08-08	13	1/2"	21(1/2")	10,0	22	
T140-12-12	19	3/4"	27	15,0	30	

T550 Трубка прессуемая метрическая

Metric Standpipe

Материал (std): Бронза - UNI 5705-65

Material (std): Brass - UNI 5705-65

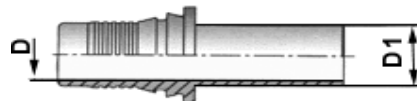

part number	hose I.D.		Dimensions		
	mm	inch	D1	D	
T550-03-06	5	3/16"	6	3,5	
T550-03-08	5	3/16"	8	3,5	
T550-04-06	6,5	1/4"	6	4,5	
T550-04-08	6,5	1/4"	8	4,5	
T550-04-10	6,5	1/4"	10	4,5	
T550-04-12	6,5	1/4"	12	4,5	
T550-05-10	8	5/16"	10	5,5	
T550-05-12	8	5/16"	12	5,5	
T550-06-12	9,5	3/8"	12	7,0	
T550-06-14	9,5	3/8"	14	7,0	
T550-08-12	13	1/2"	12	10,0	
T550-08-15	13	1/2"	15	10,0	
T550-08-16	13	1/2"	16	10,0	
T550-10-18	16	5/8"	18	12,5	
T550-10-20	16	5/8"	20	12,5	
T550-12-22	19	3/4"	22	15,0	
T550-12-25	19	3/4"	25	15,0	
T550-16-28	25	1"	28	20,0	
T550-16-30	25	1"	30	20,0	

TFLO Фланцевый коннектор

Flanged joint

Материал (std): Бронза - UNI 5705-65

Material (std): Brass - UNI 5705-65

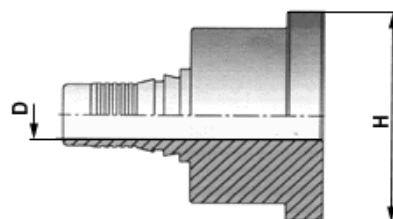

part number	hose I.D.		Dimensions		
	mm	inch	H	D	
TFLO-08-43	13	1/2"	43	10	
TFLO-12-45	19	3/4"	45	15	
TFLO-16-45	25	1"	45	20	
TFLO-20-60	32	1 1/4"	60	27	
TFLO-24-80	38	1 1/2"	80	32	
TFLO-32-80	50	2"	80	45	

TPFR Фланец, PTFE уплотнение
P.T.F.E. Lined flanged joint
Материал (std): Бронза - UNI 5705-65

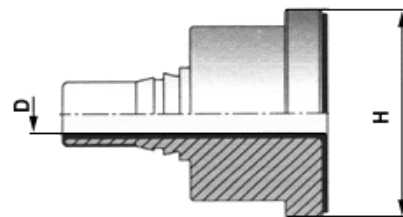
Material (std): Brass - UNI 5705-65

part number	hose I.D.		Dimensions		
	mm	inch	H	D	
TPFR-08-43	13	1/2"	43	8	
TPFR-12-45	19	3/4"	45	13	
TPFR-16-45	25	1"	45	18	
TPFR-20-60	32	1 1/4"	60	24	
TPFR-24-80	38	1 1/2"	80	29	
TPFR-32-80	50	2"	80	39	

TFPG Вращающийся фланец
Swivel flange

 According to: **UNI 2278 PN 16**
Материал (std): Бронза - UNI 5705-65

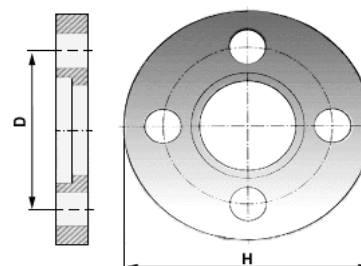
Material (std): Brass - UNI 5705-65

part number	DN		Dimensions			
	mm	inch	Ø ID Hole	D	H	
TFPG-08	15	1/2"	14	65	95	
TFPG-12	20	3/4"	14	75	105	
TFPG-16	25	1"	14	85	115	
TFPG-20	32	1 1/4"	18	100	140	
TFPG-24	40	1 1/2"	18	110	150	
TFPG-32	50	2"	18	125	165	
TFPG-40	65	2 1/2"	18	145	185	
TFPG-48	80	3"	18	160	200	
TFPG-64	100	4"	18	180	220	

TR51 Ниппель разборной, гайка BSP
BSP straight female Reusable fitting

 According to: **ISO 8434-2**
Материал (std): углеродистая сталь

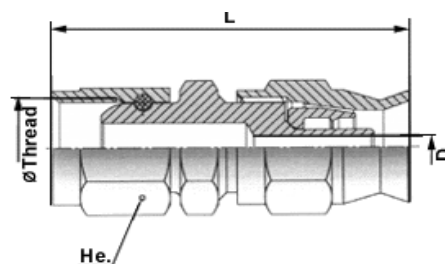
Material (std): carbon steel

part number	hose I.D.		Dimensions			
	mm	inch	Thread	D	L	He
TR51-03-04	3/16"	5	1/4"	4,0	40,0	17
TR51-04-04	1/4"	6,5	1/4"	5,5	45,5	17
TR51-05-06	5/16"	8	3/8"	7,0	47,5	22
TR51-07-08	13/32"	10,5	1/2"	9,5	53,5	27
TR51-10-12	5/8"	16	3/4"	15,0	61,0	36
TR51-14-16	7/8"	22	1"	21,0	65,0	41

